

# CONFERENCE ACCESSORIES

## 3400SERIESSTORAGECREDENZAS

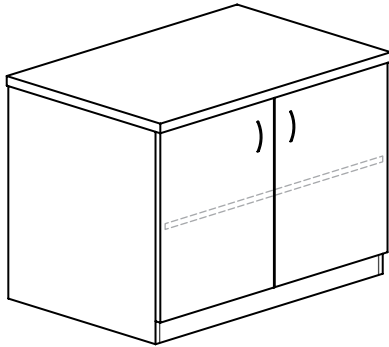

### STANDARD FEATURES

The 3400 Series Credenzas tasteful design, outstanding craftsmanship, and unique kickbase feature help create a finished look in conference rooms or private offices alike.

- HPL tops are 1/4" thick, available in 41 standard Group A finishes, and hundreds of non-standard Group B and C finishes.
  - Flat edgebanding is standard and impact resistant. Other edge options are available. **Edge Upgrades applied to front edge only.** See page 1-2.
  - Each storage area equipped with one adjustable shelf.
  - Standard 4" elliptical wire pulls available in black or brushed silver finish.
  - Kickbase is 3" high.
  - Bases have adjustable glides for leveling.
- Finish specifications on page 1-4.

Available:

- Wire management, see page 3-3.
- Additional options, see below.

### DIMENSIONS

**STARTING PRICE**  
Edge Style #10 Standard  
Refer to page 1-2 for Edge Profiles

**Front Edge Detail Upgrades**  
Add Cost to Starting Prices for these Edge Profiles.

Size	Model #	"A"	"B"	"C"	Grp. 2	Grp. 3	Grp. 4
<b>2-Door Credenzas at 29" High</b>							
20 x 30 x 29	3400203029	\$857	\$937	\$967	\$45	\$69	\$101
20 x 36 x 29	3400203629	\$982	\$1071	\$1104	\$49	\$83	\$122
20 x 42 x 29	3400204229	\$1200	\$1298	\$1335	\$53	\$97	\$142
20 x 48 x 29	3400204829	\$1334	\$1441	\$1480	\$56	\$110	\$162
24 x 30 x 29	3400243029	\$933	\$1023	\$1057	\$50	\$69	\$101
24 x 36 x 29	3400243629	\$1065	\$1165	\$1202	\$54	\$83	\$122
24 x 42 x 29	3400244229	\$1324	\$1434	\$1475	\$58	\$97	\$142
24 x 48 x 29	3400244829	\$1464	\$1584	\$1628	\$62	\$110	\$162
<b>2-Door Credenzas at 36" High</b>							
20 x 30 x 36	3400203036	\$910	\$1005	\$1040	\$45	\$69	\$101
20 x 36 x 36	3400203636	\$1041	\$1146	\$1185	\$49	\$83	\$122
20 x 42 x 36	3400204236	\$1270	\$1385	\$1428	\$53	\$97	\$142
20 x 48 x 36	3400204836	\$1409	\$1534	\$1581	\$56	\$110	\$162
24 x 30 x 36	3400243036	\$991	\$1098	\$1138	\$50	\$69	\$101
24 x 36 x 36	3400243636	\$1129	\$1247	\$1291	\$54	\$83	\$122
24 x 42 x 36	3400244236	\$1399	\$1528	\$1576	\$58	\$97	\$142
24 x 48 x 36	3400244836	\$1545	\$1685	\$1737	\$62	\$110	\$162
<b>4-Door Credenzas at 29" High</b>							
20 x 60 x 29	3400206029	\$1669	\$1793	\$1840	\$64	\$138	\$203
20 x 72 x 29	3400207229	\$1913	\$2056	\$2109	\$72	\$166	\$243
20 x 84 x 29	3400208429	\$2387	\$2547	\$2606	\$80	\$193	\$284
20 x 96 x 29	3400209629	\$2655	\$2833	\$2899	\$87	\$221	\$324
24 x 60 x 29	3400246029	\$1817	\$1956	\$2008	\$69	\$138	\$203
24 x 72 x 29	3400247229	\$2092	\$2250	\$2309	\$77	\$166	\$243
24 x 84 x 29	3400248429	\$2618	\$2796	\$2862	\$85	\$193	\$284
24 x 96 x 29	3400249629	\$2917	\$3113	\$3187	\$92	\$221	\$324
<b>4-Door Credenzas at 36" High</b>							
20 x 60 x 36	3400206036	\$1775	\$1921	\$1975	\$64	\$138	\$203
20 x 72 x 36	3400207236	\$2031	\$2197	\$2259	\$72	\$166	\$243
20 x 84 x 36	3400208436	\$2525	\$2712	\$2781	\$80	\$193	\$284
20 x 96 x 36	3400209636	\$2804	\$3011	\$3088	\$87	\$221	\$324
24 x 60 x 36	3400246036	\$1933	\$2095	\$2155	\$69	\$138	\$203
24 x 72 x 36	3400247236	\$2220	\$2403	\$2472	\$77	\$166	\$243
24 x 84 x 36	3400248436	\$2769	\$2974	\$3051	\$85	\$193	\$284
24 x 96 x 36	3400249636	\$3078	\$3306	\$3390	\$92	\$221	\$324

### ADDITIONAL OPTIONS:

- Add \$75 list price for a set of (4) 3" black casters on 30" and 36" wide cabinets ONLY. Add code "CAST" to the end of the model number. Storage area height is adjusted when adding casters to maintain overall height of 36".
- Add \$105 list price for Double Door Locks. Add code "DDL" to the end of the model number. (Locks (1) pair of doors).

# CONFERENCE ACCESSORIES

## 3410SERIESSTORAGECRENZAS

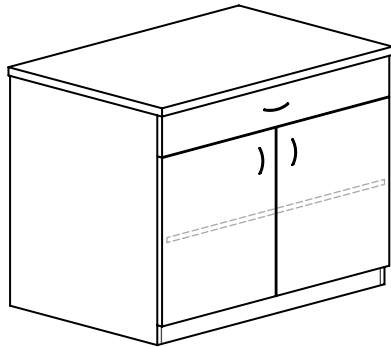

### STANDARD FEATURES

The 3410 Series Credenzas tasteful design, outstanding craftsmanship, and unique kickbase feature help create a finished look in conference rooms or private offices alike.

- HPL tops are 1/4" thick, available in 41 standard Group A finishes, and hundreds of non-standard Group B and C finishes.
- Flat edgebanding is standard and impact resistant. Other edge options are available. **Edge Upgrades applied to front edge only.** See page 1-2.
- Each storage area equipped with one adjustable shelf.
- Standard 4" elliptical wire pulls available in black or brushed silver finish.
- Kickbase is 3" high.
- Bases have adjustable glides for leveling.
- Utility drawer(s) are white vinyl clad and equipped with ball bearing slides. Finish specifications on page 1-4.

Available:

- Wire management, see page 3-3.
- Additional options, see below.

### DIMENSIONS

### STARTING PRICE

Edge Style #10 Standard  
Refer to page 1-2 for Edge Profiles

<b>Front Edge Detail Upgrades</b>		
Add Cost to Starting Prices for these Edge Profiles.		
Grp. 2	Grp. 3	Grp. 4
\$45	\$69	\$101
\$49	\$83	\$122
\$50	\$69	\$101
\$54	\$83	\$122
\$53	\$97	\$142
\$56	\$110	\$162
\$58	\$97	\$142
\$62	\$110	\$162
\$64	\$138	\$203
\$72	\$166	\$243
\$69	\$138	\$203
\$77	\$166	\$243
\$80	\$193	\$284
\$87	\$221	\$324
\$85	\$193	\$284
\$92	\$221	\$324

Size	Model #	"A"	"B"	"C"
<b>2-Door Credenzas with 1 Drawer at 36" High</b>				
20 x 30 x 36	3410203036	\$1156	\$1251	\$1286
20 x 36 x 36	3410203636	\$1311	\$1416	\$1455
24 x 30 x 36	3410243036	\$1236	\$1344	\$1386
24 x 36 x 36	3410243636	\$1399	\$1517	\$1561
<b>2-Door Credenzas with 2 Drawers at 36" High</b>				
20 x 42 x 36	3410204236	\$1706	\$1821	\$1864
20 x 48 x 36	3410204836	\$1878	\$2003	\$2050
24 x 42 x 36	3410244236	\$1835	\$1964	\$2012
24 x 48 x 36	3410244836	\$2014	\$2154	\$2206
<b>4-Door Credenzas with 2 Drawers at 36" High</b>				
20 x 60 x 36	3410206036	\$2266	\$2412	\$2466
20 x 72 x 36	3410207236	\$2571	\$2738	\$2799
24 x 60 x 36	3410246036	\$2424	\$2586	\$2646
24 x 72 x 36	3410247236	\$2760	\$2944	\$3012
<b>4-Door Credenzas with 4 Drawers at 36" High</b>				
20 x 84 x 36	3410208436	\$3397	\$3584	\$3653
20 x 96 x 36	3410209636	\$3742	\$3949	\$4026
24 x 84 x 36	3410248436	\$3641	\$3846	\$3923
24 x 96 x 36	3410249636	\$4016	\$4243	\$4328

### ADDITIONAL OPTIONS:

- Add \$75 list price for a set of (4) 3" black casters on 30" and 36" wide cabinets ONLY. Add code "CAST" to the end of the model number. Storage area height is adjusted when adding casters to maintain overall height of 36".
- Add \$105 list price for Double Door Locks. Add code "DDL" to the end of the model number. (Locks (1) pair of doors).

