

## Credenzas & Hutches

### Features:

- 1" th. TFL (thermally fused laminate) worksurfaces, 1" th. TFL end panels where applicable, 3/4" TFL back panels, 3/4" pedestal construction. Quick braces or half legs are used for intermediate support of worksurfaces where applicable.
- Credenzas with storage cabinets have a 3/4" thick adjustable shelf 14" deep to allow easy access to bottom shelf.
- Credenza back panels have a scallop grommet on center near the worksurface for routing wires.
- All exposed edges in a PVC free impact resistant ABS edgebanding. All TFL finishes have matching edgebanding.
- There are four styles of drawer pulls to choose from. Each pull is available in either black or brushed steel, providing a choice of 8 different pull options to accent the credenza. See the inside back cover of the catalog for pull selections.
- Black drawers with full extension metal ball bearing drawer slides.
- Each drawer pedestal comes standard with a lock. A single lock will secure the bottom two drawers.
- File drawers accommodate standard letter width filing, letter size lateral filing or legal size lateral filing. File drawers are designed to accommodate standard hanging file folders only and should not be used for general utility use.
- All credenzas have adjustable glides for leveling purposes. Finished height is 28-3/4 including leveler.
- Credenzas require minor assembly. Shipped in components such as box box file pedestals, storage cabinets etc..
- All hutches, hutch bookcases, hutch curved end bookcases and over storage units ship assembled.
- Hutch cradles are shipped unassembled. Separate organizer units are shipped unassembled.
- All hardware necessary for assembly is included. Assembly is easy using simple hand tools.
- Hutch TFL doors, aluminum doors and aluminocoat doors do not get handles. The bottom edge of the doors act as its own handle.
- Aluminum doors and Aluminocoat doors come with frosted acrylic inserts. Locks are not available on aluminum hutch doors.
- Fabric covered tack boards are secured in place using the supplied velcro and 2 support clips.
- 2" Valance below storage area.
- Hutches are secured into place using a double sided foam tape.

### Finishes:

- 10 Standard Flex TFL finishes.
- 10 Standard Flex ABS matching edgeband finishes.
- 8 Door and drawer pull options.
- See the inside back cover of this price guide for finish options.
- See page 11-1 for details on two tone finishes.

### Building your model number:

FCBB2060	BC	PEB	
Model #	Finish	Pull Style	Options (if applicable)

To order please provide the following information:

1. Model number.
2. Finish - See the inside back cover of the catalog for color selection.
3. Pull style - See the inside back cover of the catalog for pull selection.
4. Options - if applicable.

### Standard Edge Treatment:

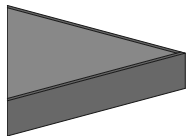

Standard Edge Trim

### Optional Edge Treatment:

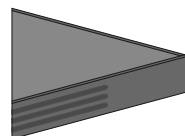

Three Groove Edge on worksurface  
List Price: \$45.00 per top  
Model # P13G

### Grain direction chart:

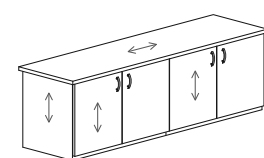
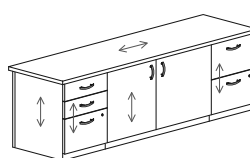
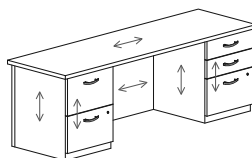
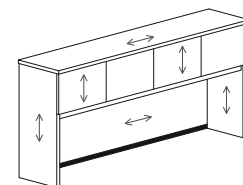
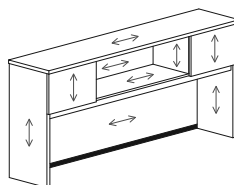
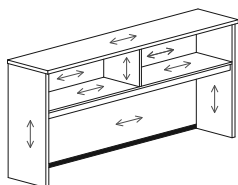

## Kneespace Credenzas

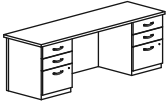
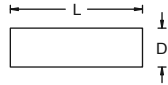

Size D x L x H	Model #	List Price	Weight
20 x 60 x 29	FCBB2060	1,288.00	189
20 x 66 x 29	FCBB2066	1,303.00	196
20 x 72 x 29	FCBB2072	1,315.00	202

24 x 60 x 29	FCBB2460	1,300.00	216
24 x 66 x 29	FCBB2466	1,320.00	223
24 x 72 x 29	FCBB2472	1,355.00	230

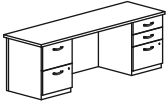

20 x 60 x 29	FCFB2060	1,288.00	186
20 x 66 x 29	FCFB2066	1,303.00	193
20 x 72 x 29	FCFB2072	1,315.00	200

24 x 60 x 29	FCFB2460	1,300.00	213
24 x 66 x 29	FCFB2466	1,320.00	220
24 x 72 x 29	FCFB2472	1,355.00	228

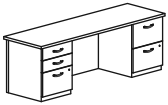

20 x 60 x 29	FCBF2060	1,288.00	186
20 x 66 x 29	FCBF2066	1,303.00	193
20 x 72 x 29	FCBF2072	1,315.00	200

24 x 60 x 29	FCBF2460	1,300.00	213
24 x 66 x 29	FCBF2466	1,320.00	220
24 x 72 x 29	FCBF2472	1,355.00	228

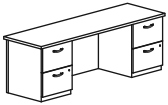

20 x 60 x 29	FCFF2060	1,288.00	184
20 x 66 x 29	FCFF2066	1,303.00	190
20 x 72 x 29	FCFF2072	1,315.00	197

24 x 60 x 29	FCFF2460	1,300.00	211
24 x 66 x 29	FCFF2466	1,320.00	218
24 x 72 x 29	FCFF2472	1,355.00	225

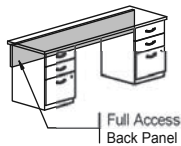

### Flex Option:

- Full Access Credenza: The credenza has an 8" high back panel that allows access to the wall. Specify: **FAB** at the end on the credenza model number. Example: A 20 x 72 credenza with two BBF pedestals and a full access back panel would have a model number of: FCBB2072-FAB.

### Optional Edge Treatment:

- Select the Three Groove Edge for \$45.00 list price per credenza top. Specify P13G at the end of the model number.

## Single Pedestal Credenzas

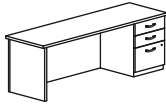
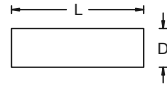

Size D x L x H	Model #	List Price	Weight
20 x 60 x 29	FCPB2060	845.00	145
20 x 66 x 29	FCPB2066	868.00	152
20 x 72 x 29	FCPB2072	888.00	158
24 x 60 x 29	FCPB2460	928.00	165
24 x 66 x 29	FCPB2466	958.00	172
24 x 72 x 29	FCPB2472	980.00	179

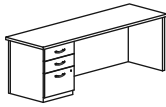

20 x 60 x 29	FCBP2060	845.00	145
20 x 66 x 29	FCBP2066	868.00	152
20 x 72 x 29	FCBP2072	888.00	158
24 x 60 x 29	FCBP2460	928.00	165
24 x 66 x 29	FCBP2466	958.00	172
24 x 72 x 29	FCBP2472	980.00	179

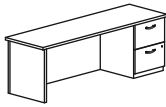

20 x 60 x 29	FCPF2060	845.00	143
20 x 66 x 29	FCPF2066	868.00	149
20 x 72 x 29	FCPF2072	888.00	156
24 x 60 x 29	FCPF2460	928.00	162
24 x 66 x 29	FCPF2466	958.00	169
24 x 72 x 29	FCPF2472	980.00	177

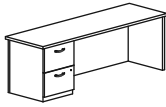

20 x 60 x 29	FCFP2060	845.00	143
20 x 66 x 29	FCFP2066	868.00	149
20 x 72 x 29	FCFP2072	888.00	156
24 x 60 x 29	FCFP2460	928.00	162
24 x 66 x 29	FCFP2466	958.00	169
24 x 72 x 29	FCFP2472	980.00	177

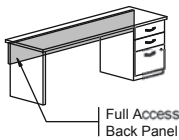

### Flex Option:

- Full Access Credenza: The credenza has an 8" high back panel that allows access to the wall. Specify: **FAB** at the end on the credenza model number. Example: A 20 x 72 credenza with a RH BBF pedestal and a full access back panel would have a model number of: FCPB2072-FAB.

### Optional Edge Treatment:

- Select the Three Groove Edge for \$45.00 list price per credenza top. Specify P13G at the end of the model number.

## Full Storage Credenzas

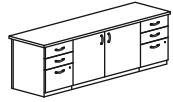
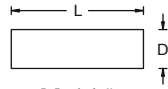

Size D x L x H	Model #	List Price	Weight
20 x 60 x 29	FCBSB2060	1,363.00	274
20 x 66 x 29	FCBSB2066	1,393.00	293
20 x 72 x 29	FCBSB2072	1,408.00	323
24 x 60 x 29	FCBSB2460	1,413.00	310
24 x 66 x 29	FCBSB2466	1,440.00	330
24 x 72 x 29	FCBSB2472	1,453.00	364

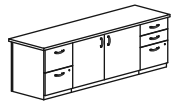

20 x 60 x 29	FCFSB2060	1,363.00	271
20 x 66 x 29	FCFSB2066	1,393.00	290
20 x 72 x 29	FCFSB2072	1,408.00	320

24 x 60 x 29	FCFSB2460	1,413.00	307
24 x 66 x 29	FCFSB2466	1,440.00	328
24 x 72 x 29	FCFSB2472	1,453.00	361

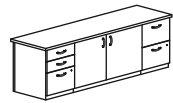

20 x 60 x 29	FCBSF2060	1,363.00	271
20 x 66 x 29	FCBSF2066	1,393.00	290
20 x 72 x 29	FCBSF2072	1,408.00	320

24 x 60 x 29	FCBSF2460	1,413.00	307
24 x 66 x 29	FCBSF2466	1,440.00	328
24 x 72 x 29	FCBSF2472	1,453.00	361

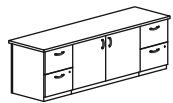

20 x 60 x 29	FCFSF2060	1,363.00	294
20 x 66 x 29	FCFSF2066	1,393.00	313
20 x 72 x 29	FCFSF2072	1,408.00	343

24 x 60 x 29	FCFSF2460	1,413.00	305
24 x 66 x 29	FCFSF2466	1,440.00	325
24 x 72 x 29	FCFSF2472	1,453.00	359

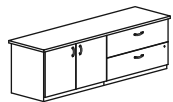

20 x 60 x 29	FCSL2060	1,315.00	246
20 x 66 x 29	FCSL2066	1,343.00	265
20 x 72 x 29	FCSL2072	1,353.00	272

24 x 60 x 29	FCSL2460	1,350.00	262
24 x 66 x 29	FCSL2466	1,373.00	282
24 x 72 x 29	FCSL2472	1,388.00	289

60" and 66" Credenzas have 30" lateral files. 72" credenzas have 36" lateral files.



20 x 60 x 29	FCLS2060	1,315.00	246
20 x 66 x 29	FCLS2066	1,343.00	265
20 x 72 x 29	FCLS2072	1,353.00	272

24 x 60 x 29	FCLS2460	1,350.00	262
24 x 66 x 29	FCLS2466	1,373.00	282
24 x 72 x 29	FCLS2472	1,388.00	289

60" and 66" Credenzas have 30" lateral files. 72" credenzas have 36" lateral files.



**Bright Idea:** Add a door lock for \$90.00  
One lock can secure two doors  
Model # DLOCK

### Features:

- Storage credenzas with doors have 1) adjustable shelf per section. Shelf is 14" deep.

### Optional Edge Treatment:

- Select the Three Groove Edge for \$45.00 list price per credenza top. Specify P13G at the end of the model number.

## Lateral File Credenzas

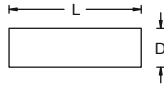
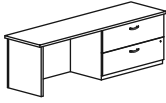

Size D x L x H	Model #	List Price	Weight
20 x 60 x 29	FCPL2060	1,038.00	180
20 x 66 x 29	FCPL2066	1,095.00	187
20 x 72 x 29	FCPL2072	1,150.00	194
24 x 60 x 29	FCPL2460	1,068.00	190
24 x 66 x 29	FCPL2466	1,120.00	197
24 x 72 x 29	FCPL2472	1,173.00	204

60" and 66" Credenzas have 30" lateral files. 72" credenzas have 36" lateral files.



20 x 60 x 29	FCLP2060	1,038.00	180
20 x 66 x 29	FCLP2066	1,095.00	187
20 x 72 x 29	FCLP2072	1,150.00	194
24 x 60 x 29	FCLP2460	1,068.00	190
24 x 66 x 29	FCLP2466	1,120.00	197
24 x 72 x 29	FCLP2472	1,173.00	204



20 x 60 x 29	FCLL2060	1,498.00	257
20 x 72 x 29	FCLL2072	1,553.00	270
24 x 60 x 29	FCLL2460	1,550.00	263
24 x 72 x 29	FCLL2472	1,588.00	278



18 x 30 x 29	FCSS1830	538.00	95
18 x 36 x 29	FCSS1836	573.00	112
18 x 42 x 29	FCSS1842	793.00	130
18 x 48 x 29	FCSS1848	858.00	158



**Bright Idea; Add a door lock for \$90.00**  
One lock can secure two doors  
Model # DLOCK

20 x 30 x 29	FCSS2030	578.00	110
20 x 36 x 29	FCSS2036	613.00	118
20 x 42 x 29	FCSS2042	838.00	137
20 x 48 x 29	FCSS2048	905.00	167

## Four Door Credenzas

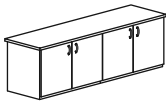

24 x 30 x 29	FCSS2430	618.00	123
24 x 36 x 29	FCSS2436	655.00	130
24 x 42 x 29	FCSS2442	893.00	151
24 x 48 x 29	FCSS2448	960.00	184

42" and 48" cabinets have a center divider inside. 1) 14" deep adjustable shelf per side.

18 x 60 x 29	FCSS1860	1,163.00	190
18 x 66 x 29	FCSS1866	1,200.00	207
18 x 72 x 29	FCSS1872	1,213.00	224

20 x 60 x 29	FCSS2060	1,175.00	220
20 x 66 x 29	FCSS2066	1,220.00	228
20 x 72 x 29	FCSS2072	1,238.00	236

24 x 60 x 29	FCSS2460	1,235.00	246
24 x 66 x 29	FCSS2466	1,273.00	254
24 x 72 x 29	FCSS2472	1,288.00	260

1) 14" deep adjustable shelf per side.

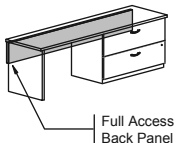

### Flex Option:

- **Full Access Credenza:** The credenza has an 8" high back panel that allows access to the wall. Specify: **FAB** at the end on the credenza model number. Example: A 20 x 72 credenza with a RH lateral file cabinet and a full access back panel would have a model number of: FCPL2072-FAB.

## Open Credenzas

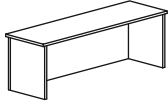
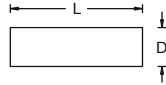

Size D x L x H	Model #	List Price	Weight
20 x 30 x 29	FCPP2030	340.00	64
20 x 36 x 29	FCPP2036	360.00	70
20 x 42 x 29	FCPP2042	370.00	77
20 x 48 x 29	FCPP2048	393.00	84
20 x 54 x 29	FCPP2054	433.00	90
20 x 60 x 29	FCPP2060	463.00	97
20 x 66 x 29	FCPP2066	473.00	103
20 x 72 x 29	FCPP2072	495.00	110
20 x 78 x 29	FCPP2078	578.00	114
20 x 84 x 29	FCPP2084	638.00	120
20 x 90 x 29	FCPP2090	680.00	127
20 x 96 x 29	FCPP2096	730.00	133



**Bright Idea;**  
Need a grommet or undercounter storage?

24 x 30 x 29	FCPP2430	340.00	73
24 x 36 x 29	FCPP2436	368.00	80
24 x 42 x 29	FCPP2442	390.00	87
24 x 48 x 29	FCPP2448	415.00	94
24 x 54 x 29	FCPP2454	463.00	102
24 x 60 x 29	FCPP2460	485.00	109
24 x 66 x 29	FCPP2466	503.00	116
24 x 72 x 29	FCPP2472	523.00	123
24 x 78 x 29	FCPP2478	605.00	128
24 x 84 x 29	FCPP2484	668.00	135
24 x 90 x 29	FCPP2490	713.00	142
24 x 96 x 29	FCPP2496	763.00	149



**FYI;** Back panels are recessed 1-1/4" on 20", 24" & 30" deep credenzas. 7-1/4" Recess on 36" deep credenzas.

30 x 36 x 29	FCPP3036	453.00	92
30 x 42 x 29	FCPP3042	485.00	101
30 x 48 x 29	FCPP3048	508.00	108
30 x 54 x 29	FCPP3054	545.00	116
30 x 60 x 29	FCPP3060	563.00	127
30 x 66 x 29	FCPP3066	598.00	135
30 x 72 x 29	FCPP3072	613.00	143
30 x 78 x 29	FCPP3078	663.00	149
30 x 84 x 29	FCPP3084	710.00	156
30 x 90 x 29	FCPP3090	758.00	165
30 x 96 x 29	FCPP3096	813.00	173



**FYI;** Half depth mid table support panels are included when applicable.

36 x 60 x 29	FCPP3660	648.00	143
36 x 72 x 29	FCPP3672	708.00	161

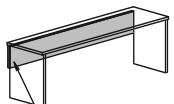

Full Access Back Panel

### Flex Option:

- Full Access Credenza: The credenza has an 8" high back panel that allows access to the wall. Specify: **FAB** at the end of the credenza model number. Example: A 20 x 72 credenza shell with a full access back panel would have a model number of: FCPP2072-FAB.

### Optional Edge Treatment:

- Select the Three Groove Edge for \$45.00 list price per credenza top. Specify P13G at the end of the model number.

## Low Profile Storage

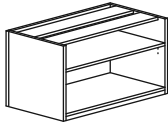
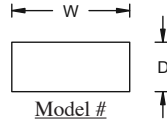

Size D x L x H	Model #	List Price	Weight
<b>Open Storage</b>			
16-7/8 x 24 x 21	FLSB1824	308.00	44
22-5/8 x 24 x 21	FLSB2424	345.00	54
16-7/8 x 30 x 21	FLSB1830	360.00	51
22-5/8 x 30 x 21	FLSB2430	405.00	63
16-7/8 x 36 x 21	FLSB1836	408.00	58
22-5/8 x 36 x 21	FLSB2436	440.00	71

Requires a top. See page 6-8 for tops. Overall height with standard TFL top is 22" high. Middle shelf has two location settings; high as shown for 12" clear binder storage on bottom shelf or the middle shelf can be centered on height.

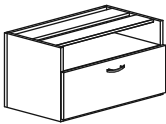

Size D x L x H	Model #	List Price	Weight
<b>Lateral File</b>			
17-3/4 x 30 x 21	FLSL1830	678.00	77
23-1/2 x 30 x 21	FLSL2430	723.00	89
17-3/4 x 36 x 21	FLSL1836	725.00	87
23-1/2 x 36 x 21	FLSL2436	773.00	100

Requires a top. See page 6-8 for tops. Overall height with standard TFL top is 22" high. Lateral file at the bottom with open storage above. Open storage section is 5-1/4" inside clear.

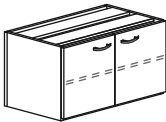

Size D x L x H	Model #	List Price	Weight
<b>Storage Cabinet</b>			
17-3/4 x 24 x 21	FLSC1824	385.00	56
23-1/2 x 24 x 21	FLSC2424	425.00	66
17-3/4 x 30 x 21	FLSC1830	428.00	67
23-1/2 x 30 x 21	FLSC2430	470.00	79
17-3/4 x 36 x 21	FLSC1836	473.00	75
23-1/2 x 36 x 21	FLSC2436	518.00	88

Requires a top. See page 6-8 for tops. Overall height with standard TFL top is 22" high. One adjustable shelf inside.



**Bright Idea; Add a door lock for \$90.00**  
One lock can secure two doors  
Model # DLOCK

## Tops for Low Profile Storage Cabinets



Size D x L x Th	Model #	List Price	Weight
18 x 24 x 1	FLST1824	108.00	12
18 x 30 x 1	FLST1830	115.00	14
18 x 36 x 1	FLST1836	130.00	17
18 x 48 x 1	FLST1848	163.00	23
18 x 54 x 1	FLST1854	188.00	26
18 x 60 x 1	FLST1860	198.00	29
18 x 66 x 1	FLST1866	215.00	32
18 x 72 x 1	FLST1872	223.00	34
18 x 78 x 1	FLST1878	248.00	37
18 x 84 x 1	FLST1884	265.00	40
18 x 90 x 1	FLST1890	290.00	43
18 x 96 x 1	FLST1896	303.00	46
24 x 24 x 1	FLST2424	120.00	15
24 x 30 x 1	FLST2430	128.00	19
24 x 36 x 1	FLST2436	140.00	23
24 x 48 x 1	FLST2448	183.00	31
24 x 54 x 1	FLST2454	208.00	34
24 x 60 x 1	FLST2460	225.00	38
24 x 66 x 1	FLST2466	248.00	42
24 x 72 x 1	FLST2472	255.00	46
24 x 78 x 1	FLST2478	280.00	49
24 x 84 x 1	FLST2484	295.00	53
24 x 90 x 1	FLST2490	320.00	57
24 x 96 x 1	FLST2496	333.00	61

Select a top from the available surfaces above for your low profile storage components.

## Cushions for Low Profile Storage



D x L x Th	Model #	Fabric Group 1	Fabric Group 2	Fabric Group 3	PVC Free	COM	COM Yardage	COL Sq Ft
					Leather Like Group 4			
18 x 24 x 1-3/4 +/-	CUSH1824	182.00	195.00	210.00	311.00	182.00	3/4	18
18 x 30 x 1-3/4 +/-	CUSH1830	195.00	209.00	224.00	325.00	195.00	3/4	18
18 x 36 x 1-3/4 +/-	CUSH1836	210.00	214.00	229.00	330.00	210.00	3/4	18
24 x 24 x 1-3/4 +/-	CUSH2424	229.00	243.00	258.00	360.00	229.00	1	20
24 x 30 x 1-3/4 +/-	CUSH2430	243.00	257.00	272.00	376.00	243.00	1	20
24 x 36 x 1-3/4 +/-	CUSH2436	258.00	273.00	288.00	406.00	258.00	1	20
24 x 48 x 1-3/4 +/-	CUSH2448	290.00	308.00	326.00	430.00	290.00	1	20

See the C.F. Stinson Multi-task and Sundance color cards for Primeway's standard upholstery fabrics. Cushion is approximately 1-3/4" thick. Cushions are free standing on finished top.

## Cool Stool

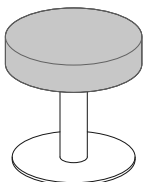

Dia x H	Model #	Fabric Group 1	Fabric Group 2	Fabric Group 3	PVC Free	COM	COL Sq Ft
					Leather Like Group 4		
18 Dia x 18	FCOOLB	705.00	717.00	732.00	847.00	705.00	3/4 18

The FCOOLB has a black metal disc base. See the C.F. Stinson Multi-task and Sundance color cards for Primeway's standard upholstery fabrics. Cushion is approximately 6" thick.

18 Dia x 18	FCOOLS	705.00	717.00	732.00	847.00	705.00	3/4 18
-------------	--------	--------	--------	--------	--------	--------	--------

The FCOOLS has a silver metal disc base. See the C.F. Stinson Multi-task and Sundance color cards for Primeway's standard upholstery fabrics. Cushion is approximately 6" thick.



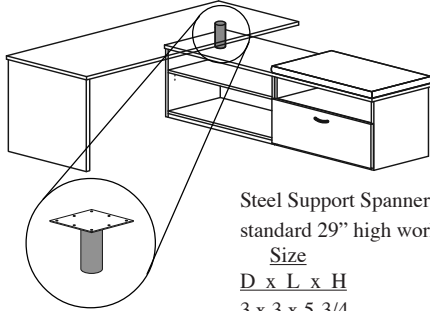

## Worksurface Components

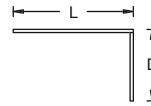
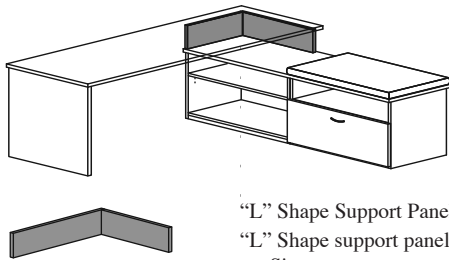

Steel Support Spanner Post 3" Dia column x 5-3/4 high. Used as a support between a low profile top and a standard 29" high worksurface. Finish: Black or Silver. Fasteners included.

Size			
D	x L	x H	
3	x 3	x 5-3/4	FSLB (Black) 220.00 4
3	x 3	x 5-3/4	FSLS (Silver) 220.00 4





 NOTE: For runoff and peninsula desks - refer to the desk section of the catalog starting at page 4-24.

"L" Shape Support Panel. Used as a support between a low profile top and a standard 29" high worksurface.

"L" Shape support panel is universal and can be used on the left or right. Hardware included. Assembly required.

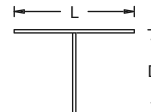
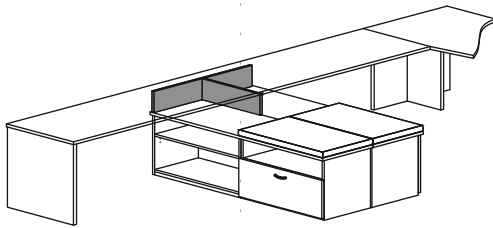
Size			
D	x L	x H	
17	x 22	x 5-3/4	FLPL1722 94.00 6
17	x 28	x 5-3/4	FLPL1728 115.00 7
22	x 22	x 5-3/4	FLPL2222 110.00 7
22	x 28	x 5-3/4	FLPL2228 133.00 8



 NOTE: For runoff and peninsula desks - refer to the desk section of the catalog starting at page 4-24.

"T" Shape Support Panel. Used as a support between a low profile top and a standard 29" high worksurface. Hardware included. Assembly required.

Size			
D	x L	x H	
17	x 22	x 5-3/4	FLPT1722 98.00 6
17	x 28	x 5-3/4	FLPT1728 119.00 7
17	x 34	x 5-3/4	FLPT1734 138.00 8
22	x 22	x 5-3/4	FLPT2222 118.00 7
22	x 28	x 5-3/4	FLPT2228 140.00 8
22	x 34	x 5-3/4	FLPT2234 169.00 9

## Hutches - 36" high

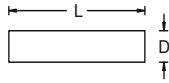

Size D x L x H	Doors	Model #	List Price	Weight
15 x 30 x 36	0	FHSO3036	368.00	71
15 x 36 x 36	0	FHSO3636	403.00	79
15 x 42 x 36	0	FHSO4236	445.00	88
15 x 48 x 36	0	FHSO4836	493.00	100
15 x 54 x 36	0	FHSO5436	538.00	109
15 x 60 x 36	0	FHSO6036	580.00	117
15 x 66 x 36	0	FHSO6636	610.00	125
15 x 72 x 36	0	FHSO7236	653.00	134
15 x 78 x 36	0	FHSO7836	818.00	142
15 x 84 x 36	0	FHSO8436	903.00	151

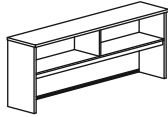

**Bright Idea:** See page 6-13 for task lights & tackboards.

30", 36" & 42" open hutches do not have a center divider.

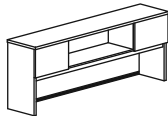

15 x 54 x 36	2	FHSTH5436	660.00	126
15 x 60 x 36	2	FHSTH6036	703.00	135
15 x 66 x 36	2	FHSTH6636	733.00	143
15 x 72 x 36	2	FHSTH7236	765.00	152
15 x 78 x 36	2	FHSTH7836	918.00	160
15 x 84 x 36	2	FHSTH8436	980.00	169

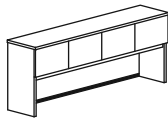

15 x 30 x 36	2	FHSTF3036	505.00	88
15 x 36 x 36	2	FHSTF3636	540.00	98
15 x 42 x 36	2	FHSTF4236	593.00	108
15 x 48 x 36	3	FHSTF4836	640.00	118
15 x 54 x 36	3	FHSTF5436	688.00	128
15 x 60 x 36	4	FHSTF6036	745.00	139
15 x 66 x 36	4	FHSTF6636	773.00	149
15 x 72 x 36	4	FHSTF7236	813.00	159
15 x 78 x 36	4	FHSTF7836	998.00	169
15 x 84 x 36	5	FHSTF8436	1,068.00	179

**Features:**

- 36" high units have 18" clear between the valance and worksurface.

**Optional Edge Treatment:**

- Select the Three Groove Edge for \$45.00 list price per hutch top. Specify P13G at the end of the model number.

**Optional Door Lock:**

- Lock a pair of side by side doors for \$90.00 list price per lock. Model # DLOCK.  
On FHSTH hutches where two doors are separated by an open section, 2 locks will be required.  
On FHSTF hutches two doors require 1 lock, three and four doors require 2 locks and five doors require 3 locks.

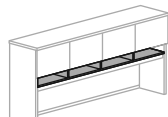

Organizer / Sorter Cubby:	Model	Price	Organizer / Sorter Cubby:	Model	Price
30 hutch organizer	FHO30	170.00	60 hutch organizer	FHO60	308.00
36 hutch organizer	FHO36	190.00	66 hutch organizer	FHO66	340.00
42 hutch organizer	FHO42	228.00	72 hutch organizer	FHO72	368.00
48 hutch organizer	FHO48	248.00	78 hutch organizer	FHO78	425.00
54 hutch organizer	FHO54	280.00	84 hutch organizer	FHO84	483.00



Organizer / Sorter unit

**Organizer Features:**

- When using a sorter unit in an existing hutch, the valance below the doors is moved to the bottom of the sorter unit.
- Must be used inside a hutch, this is not a stand alone unit.
- Default finish is the same as the hutch.
- Vertical dividers align with door gaps.
- 4-1/2" high inside clear.

## Hutches - 43" high

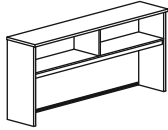
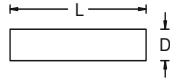

**Bright Idea:** See page 6-13 for task lights & tackboards.

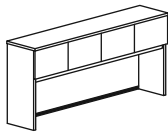
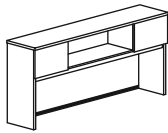

Size D x L x H	Doors	Model #	List Price	Weight
15 x 30 x 43	0	FHTO3043	463.00	81
15 x 36 x 43	0	FHTO3643	493.00	90
15 x 42 x 43	0	FHTO4243	538.00	99
15 x 48 x 43	0	FHTO4843	588.00	112
15 x 54 x 43	0	FHTO5443	638.00	121
15 x 60 x 43	0	FHTO6043	680.00	131
15 x 66 x 43	0	FHTO6643	715.00	140
15 x 72 x 43	0	FHTO7243	758.00	149
15 x 78 x 43	0	FHTO7843	918.00	158
15 x 84 x 43	0	FHTO8443	1,010.00	168

30", 36" & 42" open hutches do not have a center divider.

15 x 54 x 43	2	FHTTH5443	758.00	139
15 x 60 x 43	2	FHTTH6043	805.00	149
15 x 66 x 43	2	FHTTH6643	835.00	158
15 x 72 x 43	2	FHTTH7243	865.00	167
15 x 78 x 43	2	FHTTH7843	1,020.00	176
15 x 84 x 43	2	FHTTH8443	1,083.00	186

15 x 30 x 43	2	FHTTF3043	595.00	97
15 x 36 x 43	2	FHTTF3643	633.00	108
15 x 42 x 43	2	FHTTF4243	685.00	119
15 x 48 x 43	3	FHTTF4843	735.00	130
15 x 54 x 43	3	FHTTF5443	785.00	141
15 x 60 x 43	4	FHTTF6043	845.00	152
15 x 66 x 43	4	FHTTF6643	875.00	163
15 x 72 x 43	4	FHTTF7243	915.00	174
15 x 78 x 43	4	FHTTF7843	1,095.00	185
15 x 84 x 43	5	FHTTF8443	1,163.00	196

### Features:

- 43" high units have 25" clear between the valance and worksurface.

### Optional Edge Treatment:

- Select the Three Groove Edge for \$45.00 list price per hutch top. Specify P13G at the end of the model number.

### Optional Door Lock:

- Lock a pair of side by side doors for \$90.00 list price per lock. Model # DLOCK.  
On FHTTH hutches where two doors are separated by an open section, 2 locks will be required.  
On FHTTF hutches two doors require 1 lock, three and four doors require 2 locks and five doors require 3 locks.

Organizer / Sorter Cubby:	Model	Price	Organizer / Sorter Cubby:	Model	Price
30 hutch organizer	FHO30	170.00	60 hutch organizer	FHO60	308.00
36 hutch organizer	FHO36	190.00	66 hutch organizer	FHO66	340.00
42 hutch organizer	FHO42	228.00	72 hutch organizer	FHO72	368.00
48 hutch organizer	FHO48	248.00	78 hutch organizer	FHO78	425.00
54 hutch organizer	FHO54	280.00	84 hutch organizer	FHO84	483.00

### Organizer Features:

- When using a sorter unit in an existing hutch, the valance below the doors is moved to the bottom of the sorter unit.
- Must be used inside a hutch, this is not a stand alone unit.
- Default finish is the same as the hutch.
- Vertical dividers align with door gaps.
- 4-1/2" high inside clear.

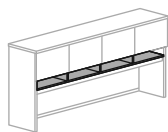

Organizer / Sorter unit

## Hutches with aluminum or alumicoat doors

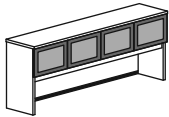
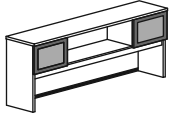

**Bright Idea; See page 6-13 for task lights & tackboards.**

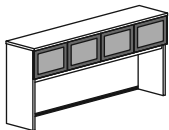
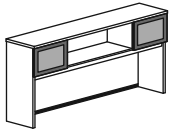

**FYI; Locks are not available on aluminum doors.**

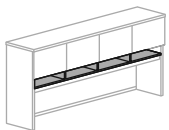

Organizer / Sorter unit

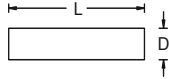

Size		Model #	Alumicoat Doors	Aluminum Doors	Weight
D	L x H		(suffix PA)	(suffix AM)	
			List Price	List Price	
15 x	54 x 36	2 FHSAH5436	900.00	1,120.00	120
15 x	60 x 36	2 FHSAH6036	943.00	1,160.00	128
15 x	66 x 36	2 FHSAH6636	973.00	1,223.00	137
15 x	72 x 36	2 FHSAH7236	1,005.00	1,253.00	145
15 x	78 x 36	2 FHSAH7836	1,158.00	1,440.00	154
15 x	84 x 36	2 FHSAH8436	1,220.00	1,498.00	162

For alumicoat doors; add "PA" at the end of the hutch model number, for aluminum doors add "AM" to the end of the model number.

15 x	30 x 36	2 FHSAF3036	745.00	960.00	81
15 x	36 x 36	2 FHSAF3636	780.00	1,028.00	91
15 x	42 x 36	2 FHSAF4236	833.00	1,108.00	101
15 x	48 x 36	3 FHSAF4836	1,000.00	1,473.00	110
15 x	54 x 36	3 FHSAF5436	1,048.00	1,373.00	120
15 x	60 x 36	4 FHSAF6036	1,225.00	1,678.00	130
15 x	66 x 36	4 FHSAF6636	1,253.00	1,773.00	140
15 x	72 x 36	4 FHSAF7236	1,293.00	1,808.00	149
15 x	78 x 36	4 FHSAF7836	1,478.00	2,058.00	159
15 x	84 x 36	5 FHSAF8436	1,668.00	2,403.00	170

For alumicoat doors; add "PA" at the end of the hutch model number, for aluminum doors add "AM" to the end of the model number.

15 x	54 x 43	2 FHTAH5443	998.00	1,218.00	131
15 x	60 x 43	2 FHTAH6043	1,045.00	1,263.00	141
15 x	66 x 43	2 FHTAH6643	1,075.00	1,328.00	151
15 x	72 x 43	2 FHTAH7243	1,105.00	1,355.00	161
15 x	78 x 43	2 FHTAH7843	1,260.00	1,400.00	171
15 x	84 x 43	2 FHTAH8443	1,323.00	1,600.00	181

For alumicoat doors; add "PA" at the end of the hutch model number, for aluminum doors add "AM" to the end of the model number.

15 x	30 x 43	2 FHTAF3043	835.00	1,050.00	91
15 x	36 x 43	2 FHTAF3643	873.00	1,120.00	101
15 x	42 x 43	2 FHTAF4243	925.00	1,203.00	112
15 x	48 x 43	3 FHTAF4843	1,095.00	1,480.00	122
15 x	54 x 43	3 FHTAF5443	1,145.00	1,525.00	133
15 x	60 x 43	4 FHTAF6043	1,325.00	1,778.00	143
15 x	66 x 43	4 FHTAF6643	1,355.00	1,873.00	154
15 x	72 x 43	4 FHTAF7243	1,395.00	1,910.00	165
15 x	78 x 43	4 FHTAF7843	1,575.00	2,153.00	175
15 x	84 x 43	5 FHTAF8443	1,763.00	2,498.00	187

For alumicoat doors; add "PA" at the end of the hutch model number, for aluminum doors add "AM" to the end of the model number.

### Features:

- 36" high units have 18" clear between the valance and worksurface, 43" units have 25" clear.
- Both aluminum doors and alumicoat doors have frosted acrylic inserts.

### Optional Edge Treatment:

- Select the Three Groove Edge for \$45.00 list price per hutch top. Specify P13G at the end of the model number.

Organizer / Sorter Cubby:	Model	Price	Organizer / Sorter Cubby:	Model	Price
30 hutch organizer	FHO30	170.00	60 hutch organizer	FHO60	308.00
36 hutch organizer	FHO36	190.00	66 hutch organizer	FHO66	340.00
42 hutch organizer	FHO42	228.00	72 hutch organizer	FHO72	368.00
48 hutch organizer	FHO48	248.00	78 hutch organizer	FHO78	425.00
54 hutch organizer	FHO54	280.00	84 hutch organizer	FHO84	483.00

### Organizer Features:

- When using a sorter unit in an existing hutch, the valance below the doors is moved to the bottom of the sorter unit. Must be used inside a hutch, this is not a stand alone unit.
- Default finish is the same as the hutch.
- Vertical dividers align with door gaps.
- 4-1/2" high inside clear.

## Tack Boards & Tasklights

36" High Hutch Tackboards

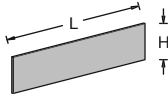

Hutch Size	Tackboard Size		Model #	Primeways Std Fabric
	L	H		
30" Hutch	28	16	FHTB3036	188.00
36" Hutch	34	16	FHTB3636	200.00
42" Hutch	40	16	FHTB4236	213.00
48" Hutch	46	16	FHTB4836	228.00
54" Hutch	52	16	FHTB5436	243.00
60" Hutch	58	16	FHTB6036	263.00
66" Hutch	64	16	FHTB6636	290.00
72" Hutch	70	16	FHTB7236	310.00
78" Hutch	76	16	FHTB7836	343.00
84" Hutch	82	16	FHTB8436	373.00

These tackboards fit onto the lower inside back of a 36" high hutch - fasteners included - field installed. See C.F. Stinson Value 1.2.3 color card for Primeway's standard tackboard fabric samples.

43" High Hutch Tackboards

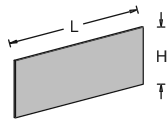

30" Hutch	28	23	FHTB3043	223.00
36" Hutch	34	23	FHTB3643	243.00
42" Hutch	40	23	FHTB4243	260.00
48" Hutch	46	23	FHTB4843	275.00
54" Hutch	52	23	FHTB5443	298.00
60" Hutch	58	23	FHTB6043	320.00
66" Hutch	64	23	FHTB6643	353.00
72" Hutch	70	23	FHTB7243	375.00
78" Hutch	76	23	FHTB7843	415.00
84" Hutch	82	23	FHTB8443	450.00

These tackboards fit onto the lower inside back of a 43" high hutch - fasteners included - field installed. See C.F. Stinson Value 1.2.3 color card for Primeway's standard tackboard fabric samples.

Wall Hung Tackboards

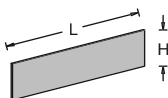

30" Overstorage	30	18	FHFTB30	248.00
36" Overstorage	36	18	FHFTB36	260.00
42" Overstorage	42	18	FHFTB42	275.00
48" Overstorage	48	18	FHFTB48	290.00
54" Overstorage	54	18	FHFTB54	308.00
60" Overstorage	60	18	FHFTB60	325.00
66" Overstorage	66	18	FHFTB66	358.00
72" Overstorage	72	18	FHFTB72	378.00

Often used between a wall hung overstorage cabinet and the worksurface - "Z" clips included. Field installed. See C.F. Stinson Value 1.2.3 color card for Primeway's standard tackboard fabric samples.

Task Lights

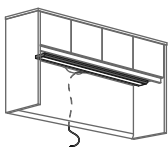

View of hutch looking up from below to see the task light behind the valance. Tasklight cord is typically routed out the back of the hutch just below the shelf.

Size	Model #	List Price	Weight
24" Tasklight	FHTL24	143.00	4
36" Tasklight	FHTL36	153.00	5
48" Tasklight	FHTL48	178.00	7

**Features:** TCLP compliant, energy-efficient fluorescent 3,500° K T5 task light with electronic ballast. Quick start light fixture operates at 20 kilohertz. Fixture color is black, bulb color warm white.

## Hutch Style Bookcase

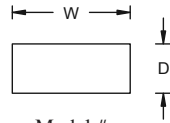

<u>Size</u> D x W x H	<u>Model #</u>	<u>List Price</u>	<u>Weight</u>
15 x 30 x 36	FHSBK30	405.00	102
15 x 36 x 36	FHSBK36	443.00	117
15 x 30 x 43	FHTBK30	488.00	111
15 x 36 x 43	FHTBK36	525.00	127

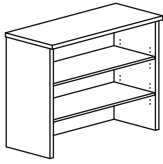

For use on standard two door storage cabinets and lateral files. Not a stand alone item. Shelves are adjustable. Hutch fastens to surface using two sided foam tape.

## Hutch Style Curved Bookcase

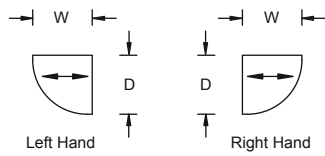

<u>Size</u> D x W x H	<u>Model #</u>	<u>List Price</u>	<u>Weight</u>
<b>Left Hand</b>			
15 x 15 x 36	FHSLQ36	378.00	51
15 x 15 x 43	FHTLQ43	433.00	56
<b>Right Hand</b>			
15 x 15 x 36	FHSRQ36	378.00	51
15 x 15 x 43	FHTRQ43	433.00	56

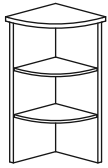

Shelves are fixed, assembly required. Depth and height match the standard storage hutch. Hutch fastens to the surface using two sided foam tape.



**FYI!** These bookcases and end of run bookcases are not stand alone. Use in conjunction with hutches.

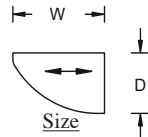

<u>Size</u> D x W x H	<u>Model #</u>	<u>List Price</u>	<u>Weight</u>
<b>Left Hand</b>			
15 x 24 x 36	FHSLE	470.00	73
15 x 24 x 43	FHTLE	530.00	79

Shelves are fixed, assembly required. Depth and height match the standard storage hutch. Hutch fastens to the surface using two sided foam tape.

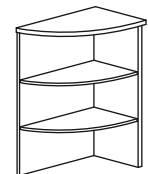

Left Hand Arch Hutch Bookcase

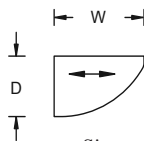

<u>Size</u> D x W x H	<u>Model #</u>	<u>List Price</u>	<u>Weight</u>
<b>Right Hand</b>			
15 x 24 x 36	FHSRE	470.00	73
15 x 24 x 43	FHTRE	530.00	79

Shelves are fixed, assembly required. Depth and height match the standard storage hutch. Hutch fastens to the surface using two sided foam tape.

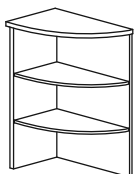

Right Hand Arch Hutch Bookcase

### Optional Edge Treatment:

- Select the Three Groove Edge for \$45.00 list price per hutch top. Specify P13G at the end of the model number.

## Overhead Storage Units (Wall Mounted)

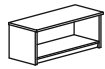
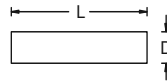

Size D x L x H	Doors	Model #	List Price	Weight
15 x 30 x 18	0	FOSO3018	340.00	49
15 x 36 x 18	0	FOSO3618	350.00	55
15 x 42 x 18	0	FOSO4218	380.00	62

Installers should verify that wall conditions are adequate for hanging cabinets.  
Mount must be secured to studs with correct fasteners.

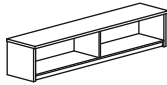

**FYI!** There are hidden wall mounts provided on the back of over storage units for ease of hanging.

15 x 48 x 18	0	FOSO4818	413.00	73
15 x 54 x 18	0	FOSO5418	453.00	80
15 x 60 x 18	0	FOSO6018	510.00	87
15 x 66 x 18	0	FOSO6618	540.00	93
15 x 72 x 18	0	FOSO7218	585.00	100

Installers should verify that wall conditions are adequate for hanging cabinets.  
Mount must be secured to stud with correct fasteners.

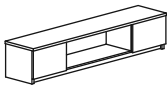

15 x 54 x 18	2	FOTH5418	538.00	98
15 x 60 x 18	2	FOTH6018	630.00	104
15 x 66 x 18	2	FOTH6618	660.00	111
15 x 72 x 18	2	FOTH7218	700.00	118

Installers should verify that wall conditions are adequate for hanging cabinets.  
Mount must be secured to stud with correct fasteners.

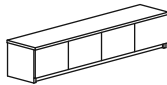

**Bright Idea!** See page 6-13 for task lights & tackboards.

15 x 30 x 18	2	FOTF3018	465.00	61
15 x 36 x 18	2	FOTF3618	485.00	70
15 x 42 x 18	2	FOTF4218	518.00	78
15 x 48 x 18	3	FOTF4818	575.00	91
15 x 54 x 18	3	FOTF5418	610.00	100
15 x 60 x 18	4	FOTF6018	665.00	108
15 x 66 x 18	4	FOTF6618	705.00	117
15 x 72 x 18	4	FOTF7218	748.00	125

Installers should verify that wall conditions are adequate for hanging cabinets. Mount must be secured to stud with correct fasteners.

### Optional Edge Treatment:

- Select the Three Groove Edge for \$45.00 list price per overstorage top. Specify P13G at the end of the model number.

### Optional Door Lock:

- Lock a pair of side by side doors for \$90.00 list price per lock. Model # DLOCK.  
On FOTH cabinets where two doors are separated by an open section, two locks will be required.  
On FOTF cabinets two doors require one lock, three doors require two locks and 4 doors require two locks.

### Overhead Storage / Hutch conversion:

Cradles allow an existing Flex series over storage cabinet to be converted into a hutch. Simply set the over storage cabinet onto the cradle and secure together with the supplied hardware and you now have a hutch. Assembly required.

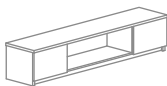

Shown with Cradle and over storage separated

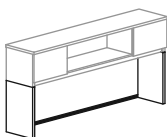

Shown assembled

Cradle to make			Cradles to make		
A 36" high hutch	Model #	List Price	A 43" high hutch	Model #	List Price
15 x 48 x 20	FHC4836	235.00	15 x 48 x 27	FHC4843	263.00
15 x 54 x 20	FHC5436	260.00	15 x 54 x 27	FHC5443	288.00
15 x 60 x 20	FHC6036	280.00	15 x 60 x 27	FHC6043	313.00
15 x 66 x 20	FHC6636	305.00	15 x 66 x 27	FHC6643	338.00
15 x 72 x 20	FHC7236	325.00	15 x 72 x 27	FHC7243	360.00